



GOYAL & CO. : TOP FLOOR, COMMERCE HOUSE 4, 100' ROAD, PRAHALADNAGAR, AHMEDABAD.
Call : 98791 14190, 98250 66918, 26931677 / 78 / 79.

ARCHITECT
APURVA AMIN

STRUCTURAL CONSULTANT
DUCON

harmony between life & living



orchid**harmony**
3 & 4 BHK apartments



orchidharmony

3 & 4 BHK apartments



Goyal & Co. and HN Safal, the leading developers in Gujarat, present **Orchid Harmony**. A luxurious residential community with amazing environment and amenities that help you create harmony between life & living.

Orchid Harmony is being developed in one of the sector of Applewoods Township. The township is being developed by Applewoods Estate Pvt. Ltd.

Transcend into a world of pure luxury and grandeur, a world immersed in a cadence of serenity and leisure, hidden underneath the warm blithe sun, far from the hissing reality... Welcome to the one of the first in its kind and most ambitious projects in the city of Ahmedabad.

Orchid Harmony spells out the promise of a convenient and comfortable lifestyle. At Orchid Harmony, unique architectural details combine in perfect harmony to provide elegant living spaces and vast open spaces.





AMENITIES

Embellished by landscaped areas, manicured gardens & lovely views, Orchid Harmony is miniature paradise. The Home, in modern times is not a mere residential type; it is the ultimate heaven where you shed the rigors of a busy day; it is a real estate goldmine with great harmony between green environs & peaceful living.





orchid**harmony**
3 & 4 BHK apartments

truly!!! harmonious
between life & living



orchidharmony



3 BHK UNIT
1876 SQ.FT.(S.B.UP)

BLOCK : C-1, C-2 & C-3



3 BHK UNIT

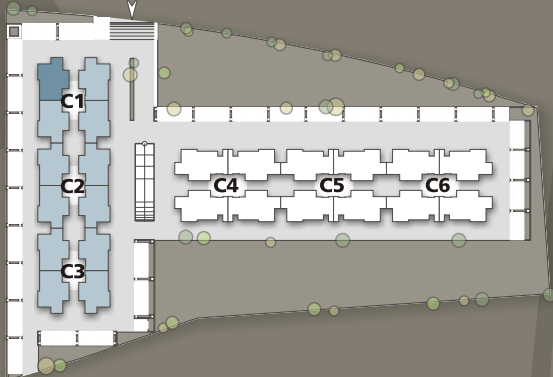

4 BHK UNIT

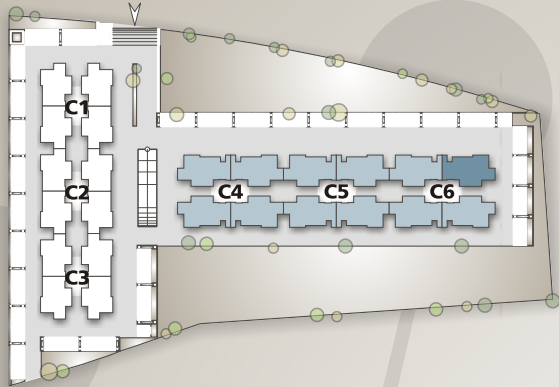

1	ENTRANCE	4'0" X 5'11"
1A	VESTIBULE	6'3" X 5'2"
2	BED ROOM -1	11'0" X 13'6"
2A	TOILET	5'0" X 7'0"
3	DRAWING ROOM	12'0" X 18'2"
3A	VERANDAH	10'0" X 6'0"
4	DINING	10'5" X 10'11"
5	KITCHEN	14'0" X 8'6"
5A	STORE	4'0" X 6'10"
5B	KITCHEN-YARD	5'0" X 6'6"
6	GENERAL TOILET	6'6" X 6'4"
7	BED ROOM-2	10'0" X 12'6"
8	BED ROOM-3	11'0" X 14'6"
8A	TOILET	5'6" X 7'0"
9	BED ROOM-4	17'0" X 12'0"
9A	TOILET	5'6" X 7'1"
10	FLOWER BED	19" WIDE

4 BHK UNIT 2300 SQ.FT.(S.B.UP)

BLOCK : C-4, C-5 & C-6

orchidharmony



SPECIFICATION

- FLOORING

KITCHEN

DOORS

WINDOWS

TOILETS

ELECTRIFICATION

COLOUR
- : Vitrified Tiles in Living/Dining & Bed Rooms. Wooden flooring in Master Bedroom

: Vitrified tiles, Granite platform with S.S. sink, Kota Stone floor in wash area & Balcony Ceramic Tiles

: Main Door Polish Natural Veneer & other Flush doors

: Fully glazed sliding aluminum windows

: Glazed / Ceramic Tiles upto Lintel Level, Counter basin and Shower panel in Master Bedroom.
EWC Couple Closet, CP Brass Fittings – Jaguar / equivalent

: Concealed Copper Wiring with Modular Switches & MCB distribution Panel

: Internal - Lime Stone Finish & Exterior-100% Acrylic paint

- SALIENT FEATURES :
- 1) 3 Automatic elevators for every block.

2) Well designed entrance foyers.

3) Security with intercom facility.

4) Well equipped Fire Hydrant System in every block.

5) DTH satellite TV connection

6) All internal roads of R.C.C. / Pattern designed Stone Paving.

7) Well planned parking spaces

8) Lush green environs with beautiful landscaping

KEY PLAN

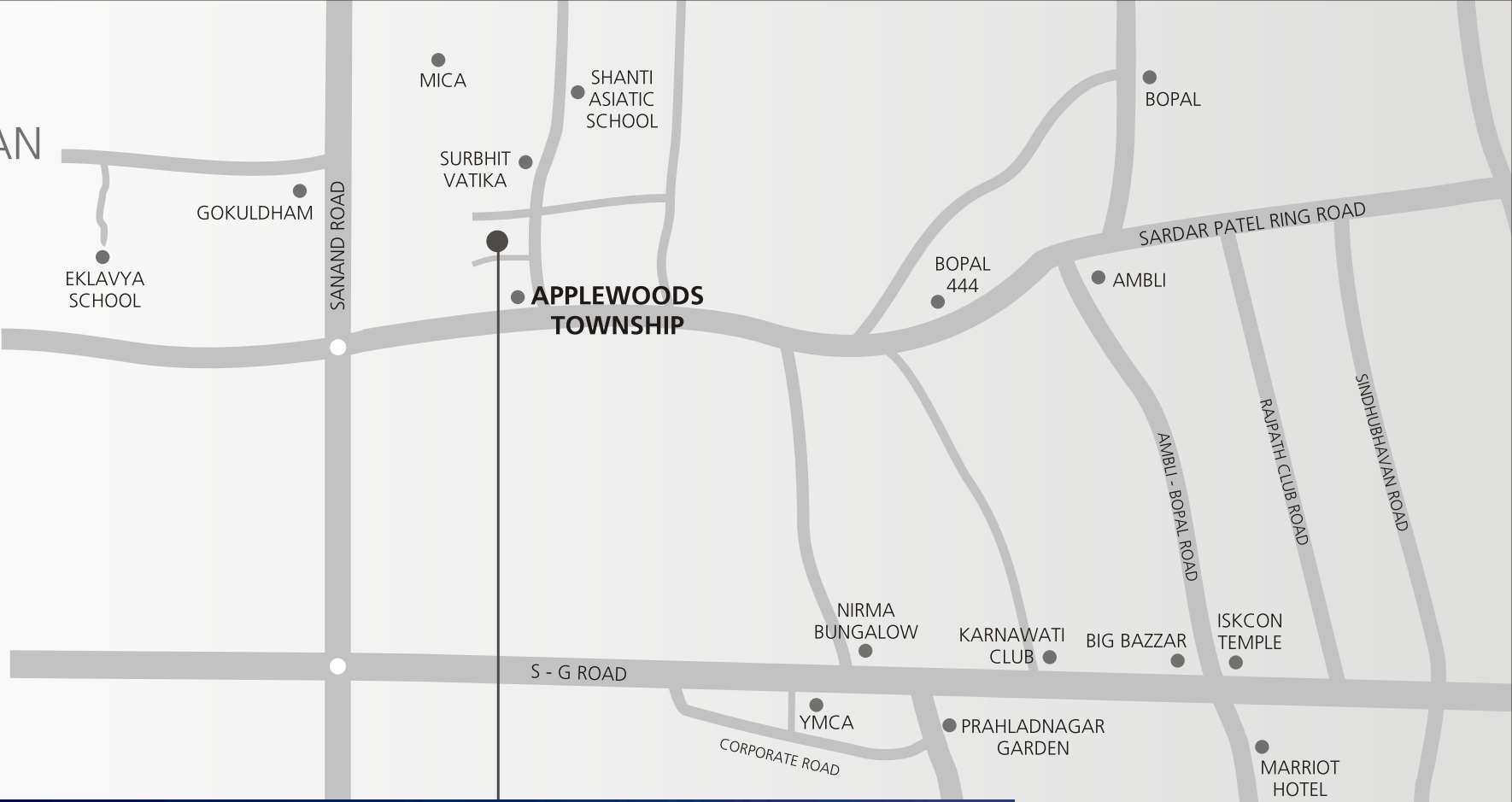

orchidharmony

3 & 4 BHK apartments

Site : At Applewoods, S. P. Ring Road

Special Notes :

The developers reserve the rights to change or revise or make any modifications, additions, omissions or alterations in the scheme as a whole or any part thereof or any details therein, at their sole discretion without any prior notice. Such changes would be binding to all the members.

All the architectural and interior views in brochure are computer graphic simulated interpretation of the actual property.

All the dimensions given are approximate & from unfinished surfaces.

This brochure is just for an easy presentation of the project and should not be treated as a legal document.

Additional details as per attached leaflet herewith.